

# PRX Series – Compact Switches

## PRX-10, PRX-20, PRX-30, PRX-40, PRX-50, PRX-70

- Easy to install
- No standby power requirements
- Reliable for over 1 million cycles
- Interchangeable with existing sensors
- Hermetically sealed for longer performance

The PRX series from Gems offers a versatile line of low cost, general purpose proximity sensors designed for dry applications. Constructed out of ABS and UL approved material, the PRX series has no standby power requirements and no moving parts. Proximity sensors are hermetically sealed for long lasting performance and are easy to install for a variety of applications.

### Specifications

<b>Housing Material</b>	ABS
<b>Operating Temperature</b>	32°F to 212°F (0°C to 100°C)
<b>Switch</b>	SPST, N.O.
<b>Voltage, Max.</b>	160 Vdc
<b>Current, Max.</b>	0.5 Amps
<b>Vibration Resistance</b>	10 to 55 Hz

### Typical Applications

- General purpose
- Household appliances
- Security systems
- Door interlocks
- Safety interlocks
- Position indication
- Equipment automation

#### PRX-10

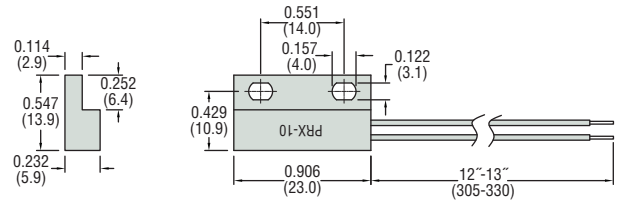

#### PRX-20

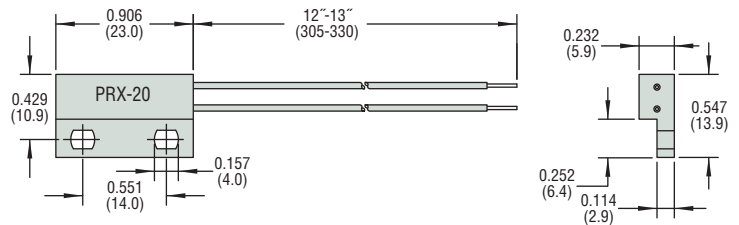

#### PRX-30

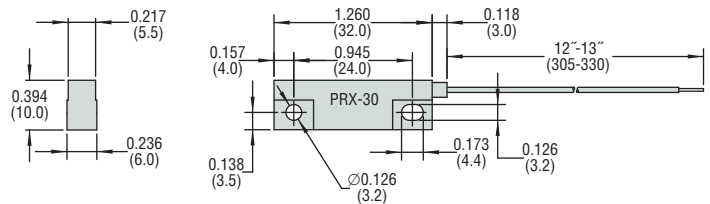

#### PRX-40

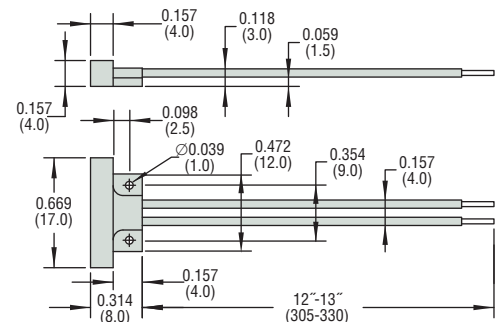
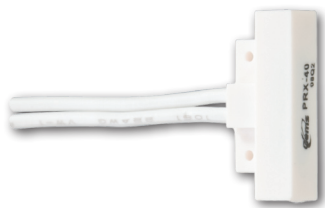

PRX-50

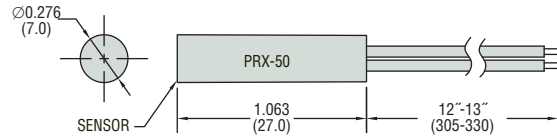

PRX-70

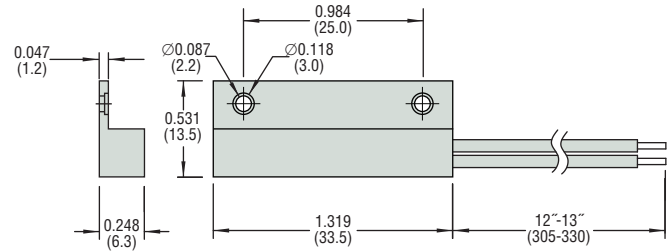

How To Order – Switches

Select by Part Number based on operational requirements. All proximity switches below come with matching magnets included.

Series	Operating Temperature	Contact Rating	Switch Open Distance, Min.	Switch Close Distance, Min.	Part Number
PRX-10	14°F to 176°F (-10°C to +80°C)	10 VA	1.02 inch (26 mm)	0.63 inch (16 mm)	225951
PRX-20	14°F to 176°F (-10°C to +80°C)	10 VA	1.30 inch (33 mm)	0.79 inch (20 mm)	225952
PRX-30	14°F to 176°F (-10°C to +80°C)	10 VA	1.02 inch (26 mm)	0.63 inch (16 mm)	225953
PRX-40	14°F to 176°F (-10°C to +80°C)	10 VA	1.30 inch (33 mm)	0.35 inch (9 mm)	225954
PRX-50	14°F to 140°F (-10°C to +60°C)	10 VA	1.57 inch (40 mm)	0.67 inch (17 mm)	225955
PRX-70	14°F to 140°F (-10°C to +60°C)	50 VA	1.97 inch (50 mm)	0.71 inch (16 mm)	225956

- Notes:  
 1. Product options include: Lead length, Activation Magnet and 22 Gage Wire. Please contact Gems for these options.  
 2. Lead time 2 weeks. A minimum piece order is required; please contact factory .

Actuating Magnets

Ferrite

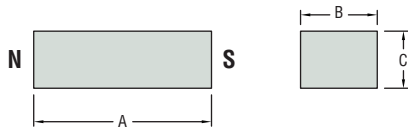

Neo

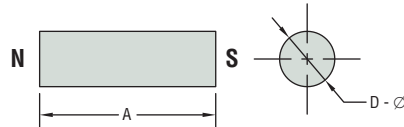

How To Order – Magnets

Magnets for the above Proximity Switch series can be ordered separately. Specify Part Number based on series switch with which the magnet is to be paired.

Switch Series	Magnet Type	Dimensions – inch (mm)				Part Number
		A	B	C	D – Ø	
PRX-10 PRX-20 PRX-30	Ferrite	1 (25.5)	0.43 (11)	0.35 (9)	—	226618
PRX-40	Neo	0.62 (15.8)	—	—	0.11 (2.8)	226621
PRX-50	Neo	0.79 (20.1)	—	—	0.25 (6.3)	226622
PRX-70	Neo	1.13 (28.6)	—	—	0.18 (4.7)	226623